

# PS SERIES

## PS Series Switching Power Supplies



PS Series  
Capable of supplying up to 90 Watts  
(AV01 DIN Rail not included)

### Up to 90 W

High efficiency switching power supply capable of supplying up to 90 W

### DIN rail mounting

Easy installation

### Loop power

Ideal for supplying loop power to Veris power transducers and current sensors

### Small size

Saves panel space

### Universal voltage input

Universal voltage input from 100 to 240 Vac/110 to 340 Vdc

### High efficiency

Won't generate excessive heat in control panel

### SPECIFICATIONS

|                                  |                                                                                        |
|----------------------------------|----------------------------------------------------------------------------------------|
| Input Voltage (except PSxx-100W) | 100 to 240 Vac (85 to 264 Vac), 50/60Hz (47 to 63 Hz); 110 to 340 Vdc (105 to 370 Vdc) |
| Input Voltage (PSxx-100W)        | 100 to 120/200 to 240 Vac, Jumper Selectable 50/60 Hz (47 to 63 Hz); 240 to 370 Vdc    |
| Input Current (Typical @100 Vac) |                                                                                        |
| 7.5 W (12 and 24 Vdc)            | 0.18 A                                                                                 |
| 15 W (12 and 24 Vdc)             | 0.35 A                                                                                 |
| 30 W (12 and 24 Vdc)             | 0.7 A                                                                                  |
| 60 W                             | 1.3 A                                                                                  |
| 90 W                             | 1.1 A                                                                                  |
| Inrush Current (100 Vac)         | 15 A (7.5 W)<br>18 A (15 W and up)                                                     |
| Overcurrent Protection           | 105% min. auto-reset                                                                   |
| Ripple                           | 24 V, 4% P-P<br>12 V, 6% P-P                                                           |
| Leakage Current                  | 120 Vac, 0.5 mA max.<br>230 Vac, 1.0 mA max.                                           |
| Output Current (12 V Models)     |                                                                                        |
| 7.5 W                            | 0.6 A                                                                                  |
| 15 W                             | 1.3 A                                                                                  |
| 30 W                             | 2.5 A                                                                                  |
| Output Current (24 V Models)     |                                                                                        |
| 7.5 W                            | 0.3 A                                                                                  |
| 15 W                             | 0.65 A                                                                                 |
| 30 W                             | 1.3 A                                                                                  |
| 60 W                             | 2.5 A                                                                                  |
| 90 W                             | 3.75 A                                                                                 |
| Operating Temperature            | -25 to 75 °C (-13 to 167 °F)                                                           |
| Operating Humidity               | 20 to 90% RH non-condensing                                                            |
| Storage Temperature              | -25 to 75 °C (-13 to 167 °F)                                                           |

### DIMENSIONAL DRAWING

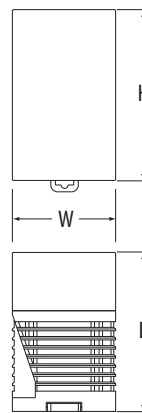

|       | H            | W              | D             | WEIGHT (APPROX.) |
|-------|--------------|----------------|---------------|------------------|
| 7.5 W | 3.0" (75 mm) | 1.9" (45 mm)   | 2.8" (70 mm)  | 130 g            |
| 15 W  | 3.6" (90 mm) | 0.9" (22.5 mm) | 3.8" (95 mm)  | 140 g            |
| 30 W  | 3.6" (90 mm) | 0.9" (22.5 mm) | 3.8" (97 mm)  | 150 g            |
| 60 W  | 3.8" (95 mm) | 1.5" (36 mm)   | 4.3" (108 mm) | 260 g            |
| 90 W  | 3.8" (95 mm) | 1.5" (36 mm)   | 4.3" (108 mm) | 310 g            |

|           |                                                                                  |
|-----------|----------------------------------------------------------------------------------|
| Terminals | Spring-up, finger-safe (when tightened); captive M3.5 screws Phillips/flat heads |
|-----------|----------------------------------------------------------------------------------|

### AGENCY APPROVALS



SUPPLYING POWER FOR ALL YOUR DC NEEDS

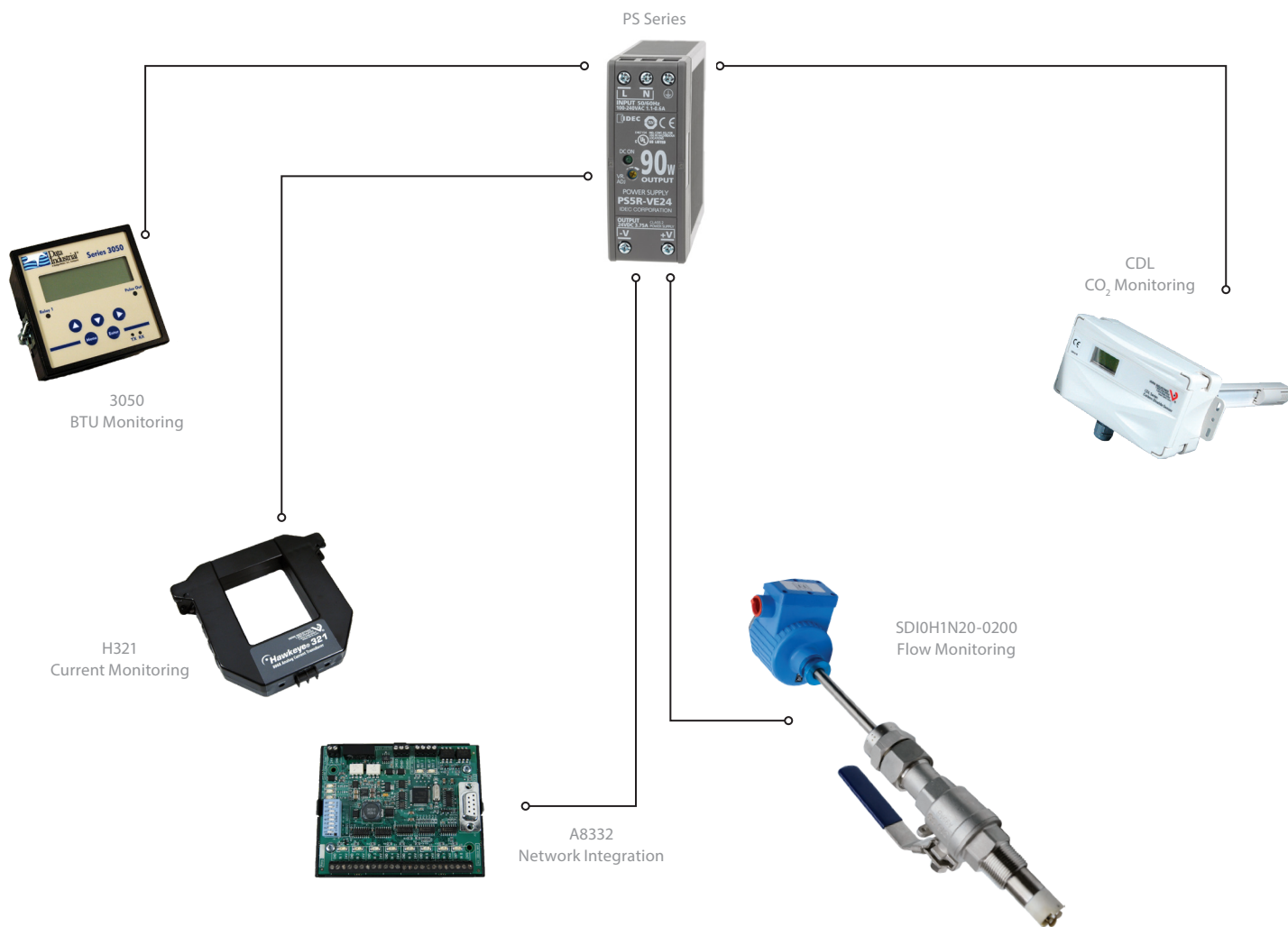

Approximate number of products that can be powered by a PS24:

|       | CDL (100 MA) | PX 2-WIRE (20 MA) | PX 3-WIRE (30 MA) | PW (125 MA) | HW (15 MA) | HW (30 MA) | SDI (20 MA) | A8332 (200 MA) | H321 (30 MA) | 3050 (280 MA) |
|-------|--------------|-------------------|-------------------|-------------|------------|------------|-------------|----------------|--------------|---------------|
| 7.5 W | 3            | 15                | 10                | 2           | 20         | 10         | 15          | 1              | 10           | 1             |
| 15 W  | 6            | 31                | 20                | 5           | 41         | 20         | 30          | 3              | 20           | 2             |
| 30 W  | 12           | 62                | 41                | 10          | 83         | 41         | 60          | 6              | 41           | 4             |
| 60 W  | 24           | 124               | 82                | 20          | 166        | 82         | 120         | 12             | 82           | 8             |
| 90 W  | 36           | 186               | 123               | 30          | 249        | 123        | 180         | 18             | 123          | 12            |

ORDERING INFORMATION

Output Watts

PS    - S    W

12 = 12 Vdc  
24 = 24 Vdc

7.5 = 7.5 Watts  
15 = 15 Watts  
30 = 30 Watts  
60\* = 60 Watts  
90\* = 90 Watts

Example:  
PS 12 - S 7.5 W

\*Available in 24 V only.

