

### Stainless Steel EnviroLine® Series Free-Standing Two-Door Enclosures

**Application -**  
Designed to house a variety of electrical and electronic controls and instruments. Provisions for optional surface mounting or rack mounting of almost any type of equipment. Provides protection from dust, dirt, water and oil. The enclosures are extra deep for applications requiring more interior space.

**Construction -**

- 0.104" Stainless Steel Type 304 & 316/316L
- Removable and interchangeable doors.
- Concealed hinge.
- Seams continuously welded and ground smooth.
- Strong, rigid construction with stiffeners welded on backs of single access boxes.
- Lifting eyes for easy handling.
- Black zinc die cast keylocking/padlocking handle.
- 3-point latching mechanism.
- Black quarter turn latches as required.
- Latch rods have rollers for easier door closing.
- Flange tough collar around all sides of door opening.
- Removable center post.
- Removable print pocket.
- Mounting channels welded horizontally on sides of interior body at top, bottom and middle for mounting optional panels or rack mounting angles.
- Oil resistant gasket.
- Ground stud on door.
- Provisions for light kit.

**Finish -**

#4 brushed finish on all exterior surfaces. Optional sub-panels are powder coated white.

**Accessories - See pages 116-123**



**IS6 - Industry Standards -**  
NEMA Type 4, 4X, 12 & Type 13  
UL Listed Type 4, 4X & 12  
CSA Type 4, 4X & 12  
IEC 60529 IP66

### 304 STAINLESS STEEL ENVIROLINE® SERIES FREE-STANDING TWO-DOOR ENCLOSURES

Catalog No.	ENCLOSURE PRODUCT CODE S4				List Price
	Height (A)	Width (B)	Depth (C)	Industry Standard	
SCE-60EL4818SSFS	60.00	48.00	18.00	IS5	8,019.42
SCE-72EL4818SSFS	72.00	48.00	18.00	IS5	8,840.69
SCE-72EL4824SSFS	72.00	48.00	24.00	IS5	9,521.55
SCE-72EL6018SSFS	72.00	60.00	18.00	IS5	9,981.99
SCE-72EL6024SSFS	72.00	60.00	24.00	IS5	10,615.02
SCE-72EL6036SSFS	72.00	60.00	36.00	IS5	12,110.83
SCE-72EL7218SSFS	72.00	72.00	18.00	IS5	10,906.00
SCE-72EL7224SSFS	72.00	72.00	24.00	IS5	11,731.26
SCE-90EL4820SSFS	90.00	48.00	20.00	IS5	10,321.52
SCE-90EL7220SSFS	90.00	72.00	20.00	IS5	12,820.70
SCE-90EL7245SSFS	90.00	72.00	24.00	IS5	13,429.38
SCE-90EL7236SSFS	90.00	72.00	36.00	IS5	15,275.91

### 316 STAINLESS STEEL ENVIROLINE® SERIES FREE-STANDING TWO-DOOR ENCLOSURES

Catalog No.	ENCLOSURE PRODUCT CODE S7				List Price
	Height (A)	Width (B)	Depth (C)	Industry Standard	
SCE-60EL4818SS6FS	60.00	48.00	18.00	IS5	9,623.31
SCE-72EL4818SS6FS	72.00	48.00	18.00	IS5	10,608.83
SCE-72EL4824SS6FS	72.00	48.00	24.00	IS5	11,425.87
SCE-72EL6018SS6FS	72.00	60.00	18.00	IS5	11,834.39
SCE-72EL6024SS6FS	72.00	60.00	24.00	IS5	12,738.03
SCE-72EL6036SS6FS	72.00	60.00	36.00	IS5	14,533.00
SCE-72EL7218SS6FS	72.00	72.00	18.00	IS5	13,087.20
SCE-72EL7224SS6FS	72.00	72.00	24.00	IS5	14,077.51
SCE-90EL4820SS6FS	90.00	48.00	20.00	IS5	12,385.82
SCE-90EL7220SS6FS	90.00	72.00	20.00	IS5	15,384.84
SCE-90EL7245SS6FS	90.00	72.00	24.00	IS5	16,115.26
SCE-90EL7236SS6FS	90.00	72.00	36.00	IS5	18,331.10

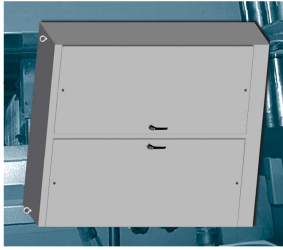

Available within 10 working days if not in stock



Phone (989) 799-6871  
Fax (989) 799-4524



### STAINLESS STEEL ENVIROLINE® SERIES FREE-STANDING TWO-DOOR ENCLOSURES

#### TECHNICAL DATA

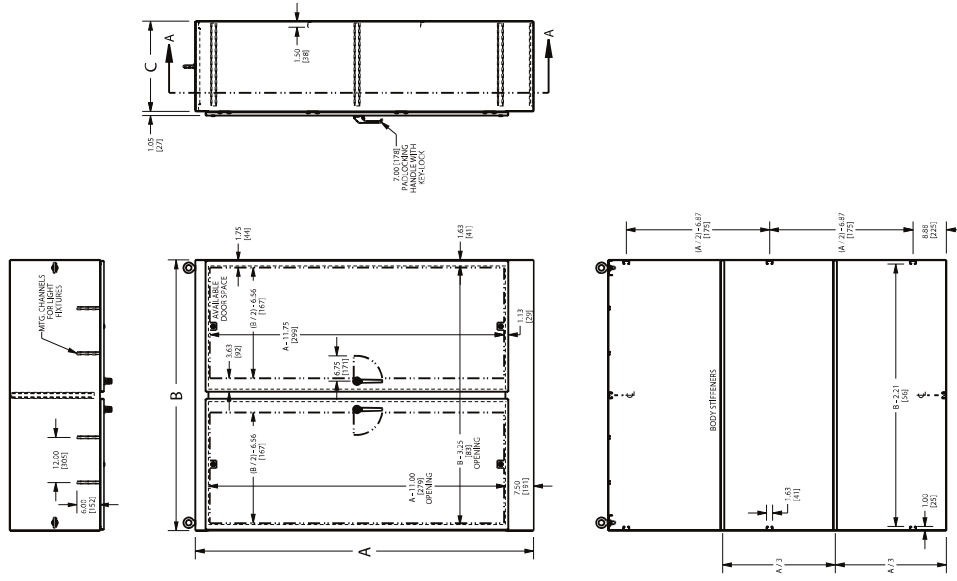

SECTION A-A

Phone (989) 799-6871  
Fax (989) 799-4524

