

Stainless Steel ELJ Consoles & Accessories

Application -

Designed to house electrical and electronic controls, instruments, and components. Provides protection from dust, dirt, oil and water. Consoles can be mounted on either of two sides to give a control surface inclined 30° or 60°. Can be mounted on desks, machines, or pedestals.

Construction -

- 0.063" stainless steel Type 304.
- Seams continuously walked and ground smooth.
- Flange tough collar around all sides of enclosure.
- Removable hinges.
- Oil-resistant gasket.
- Standoffs provided for mounting optional sub-panels.
- Cable door stops included on SCE-12C**, SCE-16C** & SCE-20C**.
- Black mini quarter turn latches.
- Latches are opened or closed with a screwdriver.
- Ground stud on door and body.
- Mounting holes in back.

Finish -

#4 brushed finish on all exterior surfaces. Optional sub-panels are powder coated white.

Options -

Can be special ordered in Type 316/316L stainless steel.

IS5 - Industry Standards -

NEMA Type 4, 4X, 12 & Type 13
UL Listed, Type 4, 4X & 12
CSA Type 4, 4X & 12
IEC 60529 IP65



STAINLESS STEEL ELJ CONSOLES

| ENCLOSURE PRODUCT CODE A1 | | | | SUB-PANEL (P3) | | | | |
|---------------------------|------------|-----------|-----------|----------------|------------------|-----------------|------------|-------|
| Catalog No. | Height (A) | Width (B) | Depth (C) | List Price (D) | Panel Height (E) | Panel Width (F) | List Price | |
| SCE-808ELUSS | 8.00 | 8.00 | 7.09 | 7.44 | 566.80 | 6.00 | 6.75 | 5.27 |
| SCE-8012ELUSS | 8.00 | 12.00 | 7.09 | 7.44 | 627.16 | 6.00 | 10.75 | 8.39 |
| SCE-8016ELUSS | 8.00 | 16.00 | 7.09 | 7.44 | 708.62 | 6.00 | 14.75 | 11.50 |
| SCE-8020ELUSS | 8.00 | 20.00 | 7.09 | 7.44 | 787.24 | 6.00 | 18.75 | 14.63 |
| SCE-12C12ELUSS | 12.00 | 12.00 | 9.09 | 10.91 | 771.99 | 9.50 | 10.75 | 13.28 |
| SCE-12C16ELUSS | 12.00 | 16.00 | 9.09 | 10.91 | 796.98 | 9.50 | 14.75 | 18.22 |
| SCE-12C20ELUSS | 12.00 | 20.00 | 9.09 | 10.91 | 817.75 | 9.50 | 18.75 | 23.16 |
| SCE-12C24ELUSS | 12.00 | 24.00 | 9.09 | 10.91 | 868.79 | 9.50 | 22.75 | 28.09 |
| SCE-16C16ELUSS | 16.00 | 16.00 | 11.09 | 14.38 | 817.75 | 14.75 | 12.88 | 19.95 |
| SCE-16C20ELUSS | 16.00 | 20.00 | 11.09 | 14.38 | 868.79 | 14.75 | 18.75 | 31.40 |
| SCE-16C24ELUSS | 16.00 | 24.00 | 11.09 | 14.38 | 957.18 | 14.75 | 22.75 | 38.10 |
| SCE-20C20ELUSS | 20.00 | 20.00 | 13.09 | 17.84 | 857.18 | 16.38 | 18.75 | 38.00 |
| SCE-20C24ELUSS | 20.00 | 24.00 | 13.09 | 17.84 | 1,100.28 | 16.38 | 22.75 | 42.30 |
| SCE-20C30ELUSS | 20.00 | 30.00 | 13.09 | 17.84 | 1,320.04 | 16.38 | 28.75 | 47.32 |

CABLE DOOR STOP

| Catalog No. | Description | For use on | Product Code | List Price |
|-------------|------------------------|----------------------|--------------|------------|
| SCE-CBL15 | 15 Inch 135° Door Stop | SCE-12C** & SCE-16C* | P2 | 13.75 |
| SCE-CBL20 | 20 Inch 135° Door Stop | SCE-20C** | P2 | 14.25 |

ACCESSORY COLUMNS AND BASES

| Catalog No. | Description | Size | Product Code | List Price |
|---------------|---------------------------------|----------------------|--------------|------------|
| SCE-16SBASESS | Stainless Steel Pedestal Base | 18.00 x 18.00 x 1.00 | P2 | 424.63 |
| SCE-24SBASESS | Stainless Steel Pedestal Base | 24.00 x 24.00 x 1.00 | P2 | 491.45 |
| SCE-44CCOLSS | Stainless Steel Straight Column | 4.00 x 4.00 | P2 | 524.13 |
| SCE-66CCOLSS | Stainless Steel Straight Column | 6.00 x 6.00 | P2 | 554.52 |

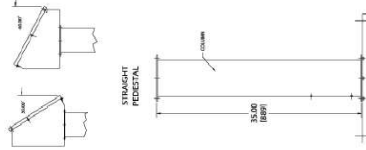

Back to
SS Operator
Systems

Phone (989) 799-6871
Fax (989) 799-4524

SCE
SAGINAW
CONTROL &
ENGINEERING
Your Enclosure Source™

STAINLESS STEEL ELJ CONSOLES TECHNICAL DATA

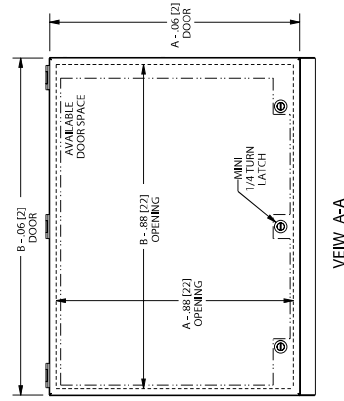
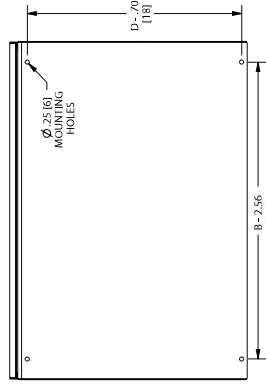
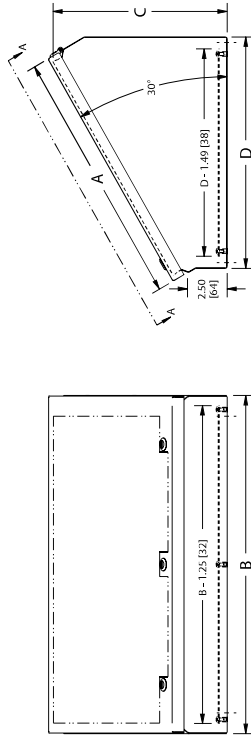

NOTES:
Provisions for cable stops on door and body when "A" >= 12.00 [305]

LATCH NOTES:
One latch centered on door horizontally if "B" <= 14.00 [356]

Two latches located 3.00 [76] from right & left side of door if "B" > 14.00 [356]

Omit center latch if "B" > 14.00 [356] and <= 20.00 [508]

SUB-PANEL NOTES:
Provisions only for sub-panel in bottom.

Phone (989) 799-6871
Fax (989) 799-4524

SCE
SAGINAW
CONTROL &
ENGINEERING
Your Enclosure Source™