

### Two-Door Disconnect Enclosures

#### Application -

Designed to house most standard type disconnects. For outdoor applications a drip shield and drain holes are required. For installation information, consult our Installation Manual at [www.saginawcontrol.com](http://www.saginawcontrol.com).

#### Construction -

- 0.104" carbon steel.
  - Seams continuously welded and ground smooth.
  - Flange trough collar around all sides of door opening.
  - Oil-resistant gasket.
  - Concealed hinges.
  - Removable and interchangeable doors.
  - 3-point latching mechanism.
  - Removable print pocket.
  - Lifting eyes for easy handling.
  - Ground studs on door and body.
  - Collar studs provided for mounting optional sub-panels.
  - Back quarter turn latches as required.
  - 15" removable floor stands.
  - Removable center post.
  - Mechanical interlock
  - No door stiffeners required.
  - Black zinc die cast corrosion proof/padlocking handle on main door with black zinc die cast padlocking handle on slave door.
- Disconnect switch (or circuit breaker) and operating mechanism are not furnished with this enclosure.**

#### Finish -

ANSI-61 gray powder coated inside and out. Optional sub-panels are powder coated white.

#### IS1 - Industry Standards -

NEMA Type 12 & Type 13  
UL Listed Type 12  
CSA Type 12  
IEC 60529 IP55

#### IS4 - Industry Standards -

NEMA Type 3R, 4, 12 & Type 13  
UL Listed Type 3R, 4, & 12  
CSA Type 3R, 4 & 12  
IEC 60529 IP66

\*\*\*Special Instructions apply for IS3, IS4 and IS6 to maintain the environmental rating of Type 3R for these parts. See the Special Instructions on the Industry Standards page in the Technical Information Section.

### TWO-DOOR ENCLOSURES WITH PROVISION FOR DISCONNECT ON RIGHT FLANGE

ENCLOSURE PRODUCT CODE A2					SUB-PANEL (P3)				
Catalog No.	Height (A)	Width (B)	Depth (C)	Industry Standard	List Price	Catalog No.	Panel Height (D)	Panel Width (E)	List Price
SCE-60XEL4912LP	60.00	49.00	12.00	IS4	2,142.65	SCE-60P48	56.00	44.00	268.38
SCE-60XEL4918LP	60.00	49.00	18.00	IS4	2,333.74	SCE-60P48	56.00	44.00	268.38
SCE-60XEL4924LP	60.00	49.00	24.00	IS4	2,524.84	SCE-60P48	56.00	44.00	268.38
SCE-60XEL6112LP	60.00	61.00	12.00	IS4	2,395.85	SCE-60P60	56.00	56.00	331.68
SCE-60XEL6118LP	60.00	61.00	18.00	IS4	2,609.64	SCE-60P60	56.00	56.00	331.68
SCE-60XEL6124LP	60.00	61.00	24.00	IS4	2,823.42	SCE-60P60	56.00	56.00	331.68
SCE-72XEL6112LP	72.00	61.00	12.00	IS4	2,853.84	SCE-72P60	68.00	56.00	394.98
SCE-72XEL6118LP	72.00	61.00	18.00	IS4	2,863.15	SCE-72P60	68.00	56.00	394.98
SCE-72X7312LP	72.00	73.00	12.00	IS3	2,947.64	SCE-72P72	68.00	68.00	470.93
SCE-72XEL7312LP	72.00	73.00	12.00	IS4	3,036.06	SCE-72P72	68.00	68.00	470.93
SCE-72X7318LP	72.00	73.00	18.00	IS3	3,202.04	SCE-72P72	68.00	68.00	470.93
SCE-72XEL7318LP	72.00	73.00	18.00	IS4	3,298.10	SCE-72P72	68.00	68.00	470.93
SCE-72X7324LP	72.00	73.00	24.00	IS3	3,457.63	SCE-72P72	68.00	68.00	470.93
SCE-72XEL7324LP	72.00	73.00	24.00	IS4	3,561.36	SCE-72P72	68.00	68.00	470.93

Part numbers that contain the letter "EL" that are over 30 inches wide have quarter turn latches on the center of the door top and bottom.



Back to Free-Standing Enclosures

Phone (989) 799-6871  
Fax (989) 799-4524



### TWO-DOOR DISCONNECT ENCLOSURES TECHNICAL DATA

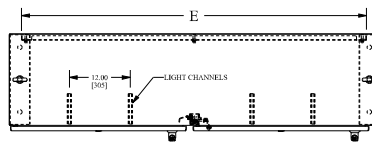

DISCONNECT NOTES:  
F = 7.81 [200] when A = 60.00 [1524]  
F = 13.38 [340] when A = 72.00 [1829]

LATCH NOTES:  
"EL" part numbers are 10.00 [254] in width (see additional latches centered top and bottom of door).

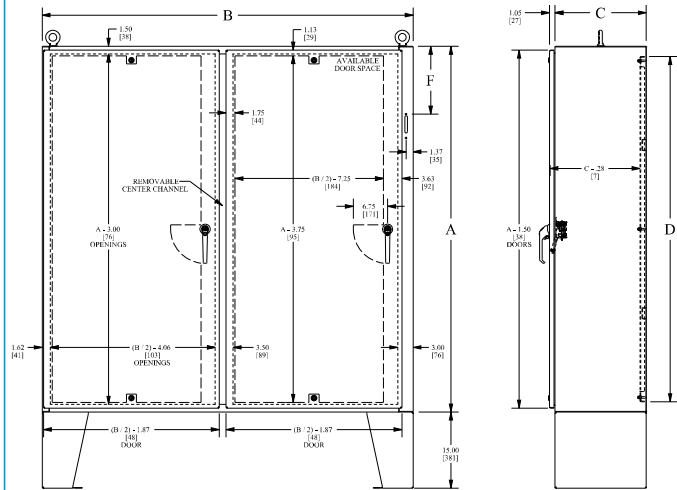

Phone (989) 799-6871  
Fax (989) 799-4524

