

STM-Series – Submittal/Technical Data

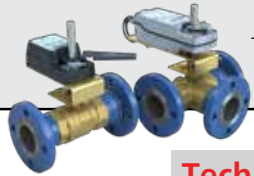

Technical Specifications

Service		Hot Water, Chilled Water, 50/50 Glycol Solutions, and 25 psig (172 kPa) Saturated Steam for HVAC Systems
Valve Fluid Temperature Limits		0 to 284°F (-18 to 140°C)
Valve Body Pressure/ Temperature Rating	Water	ANSI Class 125/150 250 psi at -20 to 100°F (29 to 38°C) 235psi at: 200°F (93°C) 218psi at: 284°F (140°C)
	Steam	25 psig (172 kPa) Saturated Steam for HVAC Systems
Maximum Close-Off Pressure	Two-Way	100 psi (689 kPa)
	Three-Way	50 psi (345 kPa)
Maximum Recommended Operating Pressure Drop		30 psi (207 kPa) for quiet service
Flow Characteristics	Two-Way	Equal Percentage
	Three-Way	Equal Percentage Flow Characteristics of In-line Port or Linear Percentage Flow Characteristics of Angle Port
Rangeability		Greater than 500:1
Leakage	Two/Three-Way	0.01% of Maximum Flow, Control Port, ANSI/FCI 70-2, Class 4
	Three-Way	1% of Maximum Flow, Bypass Port
End Connections		ANSI Class 125 Flange
Minimum Ambient Operating Temperature	-4°F (-20°C)	D24-210/DC24-310 Series Non-Spring Return Actuators
	-40°F (-40°C)	DS-180 Series Spring Return Actuators
Maximum Ambient Operating Temperature	122°F (50°C)	D24-210/DC24-310 Series Non-Spring Return Actuators
	131°F (55°C)	DS-180 Series Spring Return Actuators
Materials	Body	Brass
	Flanges	Ductile Iron
	Ball	300 Series Stainless Steel
	Stem	300 Series Stainless Steel
	Seats	Graphite Reinforced PTFE with EPDM O-Ring Backing
	Stem Seals	EPDM O-Rings
	Flow Control Disk	Amodel AS-1145HS Polyphthalamide Resin
Warranty	5 Years limited from time of shipment.	

STM - 2-Way Dimensions

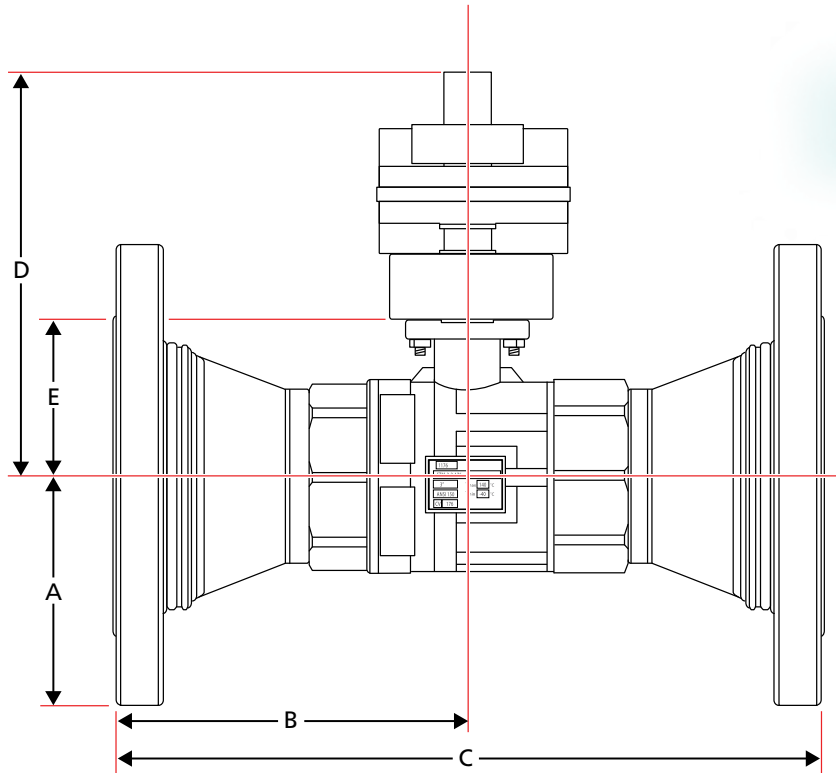
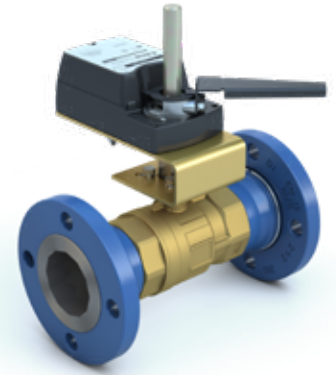

2-Way STM Dimensions

Valve Models	Size in.(mm)	Flow Coefficient		Bolt Hole Diameter	Number of Bolt Holes	A	B	C	D	E	Weight	
		Cv	Kv								lbs.	kg.
STM 250-2-47	2 1/2 (65)	47	40.7	5.50 (139)	4	3.50 (89)	5.71 (145)	11.42 (290)	10.25 (260)	2.05 (52.1)	34	15
STM 250-2-74		74	64.0									
STM 250-2-117		117	101.2									
STM 3-2-74	3 (80)	74	64.0	6.00 (152)	4	3.75 (95)	6.10 (155)	12.20 (310)	10.25 (260)	2.49 (63.2)	36	16
STM 3-2-117		117	101.2									
STM 3-2-176		176	152.2									
STM 3-2-211*		211	182.5									
STM 4-2-117	4 (100)	117	101.2	7.50 (191)	8	4.50 (114)	6.89 (175)	13.77 (350)	10.25 (260)	3.09 (75.5)	44	20
STM 4-2-176*		176	152.2									

- Allow a minimum of 4 inches for actuator removal.
- Weights are for valve bodies only.
- Dimensions may vary depending on the actuator
- Dimensions Shown are based on largest actuator available for this series.
- * Reduced Port Valve - No characterizing disc.

STM - 3-Way Dimensions

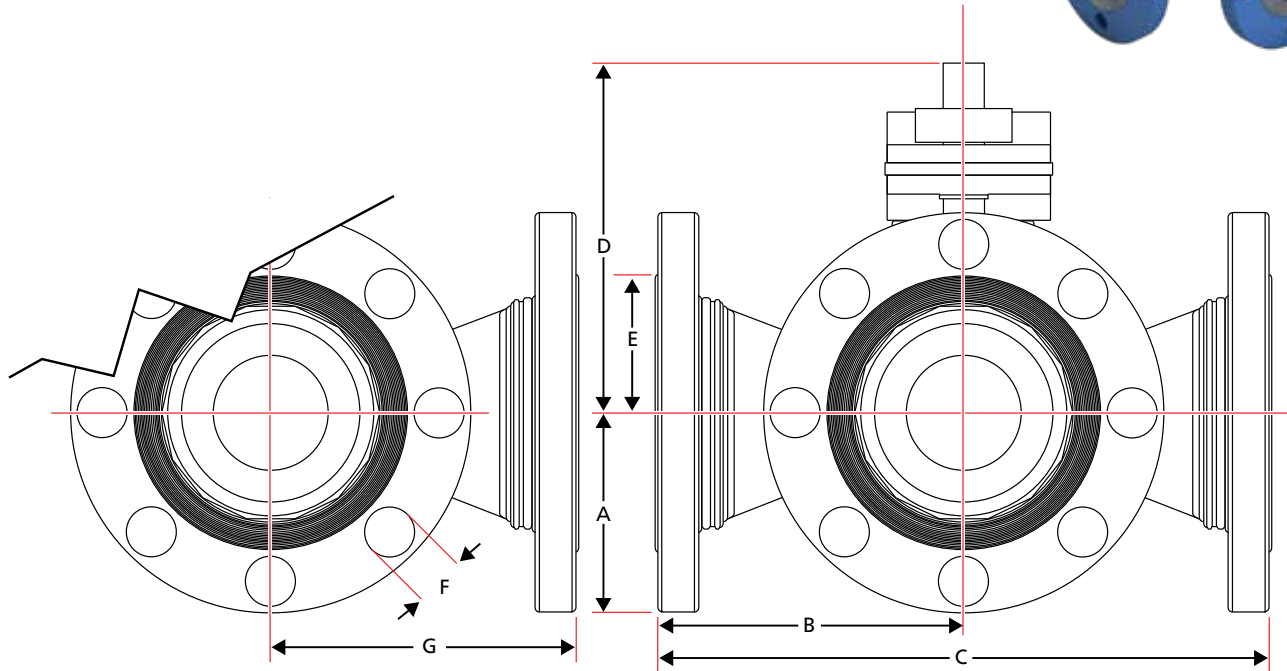

3-Way STM Dimensions

Valve Models	Size in.(mm)	Flow Coefficient		Bolt Hole Diameter	Number of Bolt Holes	A	B	C	D	E	F	G	Weight	
		Cv	Kv										lbs.	kg.
STM 250-3-47	2 1/2 (65)	47	40.7	5.50 (139)	4	3.50 (89)	5.71 (145)	11.42 (290)	10.25 (260)	2.05 (52.1)	0.75 (19.1)	5.87 (149)	43	20
STM 250-3-74		74	64.0											
STM 250-3-117		117	101.2											
STM 3-3-74	3 (80)	74	64.0	6.00 (152)	4	3.75 (95)	6.10 (155)	12.20 (310)	10.25 (260)	2.49 (63.2)	0.75 (19.1)	6.26 (159)	49	22
STM 3-3-117		117	101.2											
STM 3-3-176		176	152.2											
STM 3-3-211*		211	182.5											
STM 4-3-117	4 (100)	117	101.2	7.50 (191)	8	4.50 (114)	6.89 (175)	13.77 (350)	10.25 (260)	3.09 (75.5)	0.75 (19.1)	7.05 (179)	62	28
STM 4-3-176*		176	152.2											

- Allow a minimum of 4 inches for actuator removal.
- Weights are for valve bodies only.
- Dimensions may vary depending on the actuator
- Dimensions Shown are based on largest actuator available for this series.
- Bypass Cv/Kv is 50% of the nominal service Cv.
- * Reduced Port Valve - No characterizing disc.